

**Proposed Section AA**  
scale 1 : 50

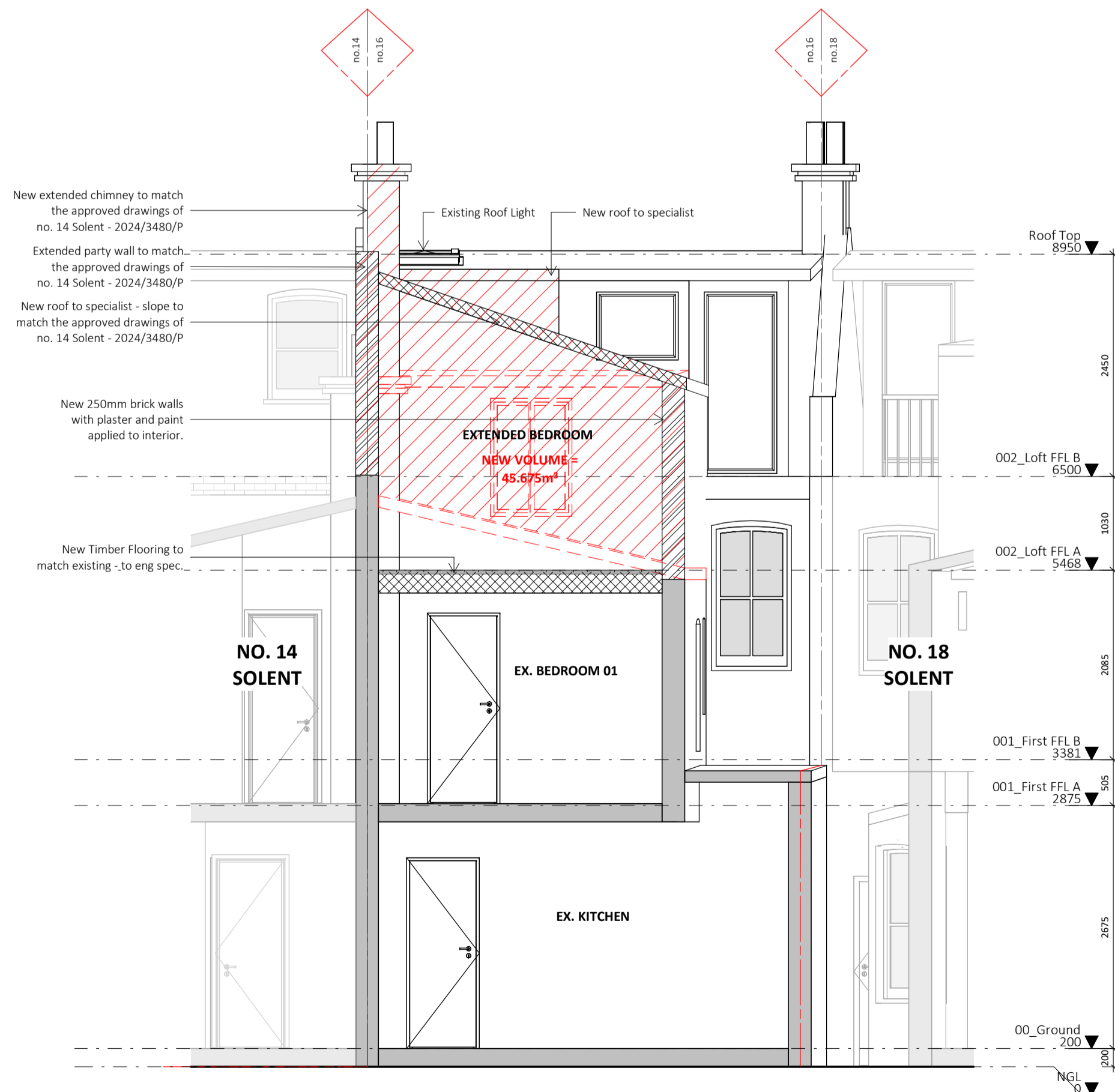

**Proposed Section BB**  
scale 1 : 50

**KEY:**

- ELEMENTS TO BE DEMOLISHED
- EXTENT OF PROPOSED NEW WORK

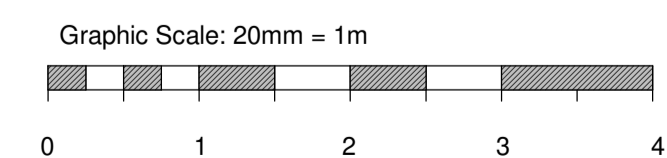

**GENERAL NOTE**  
All building work to comply with SANS 10400. Figured dimensions to be used in preference to scaling. This drawing is to be read in conjunction with other documents and/or documents by other Consultants. Contractor to verify all dimensions, levels and quantities on site prior to putting any work to hand. Specified tradenames may be substituted for 'equal or approved' subject to Architects confirmation. Contractor to adhere to all SABS codes and manufacturer's instructions. Any discrepancies to be reported to the Architect immediately. Copyright © reserved.

#	date	description	by
	09/02/2026	Issued for Information	DF
A	17/02/2026	Issued for Approval	DF
B	14/04/2026	Issued for Approval	DF

ISSUED FOR PURPOSES OF  
**Council Approval**

**Fabian Architects**  
**Make Architects & Interior Studio**

8th Floor, Protea Hotel North Wharf, 1 Lower Bree Str, Cape Town, 8001  
(t) +27 21 419 7501 / 418 9500 | (f) +27 21 419 4884 | (w) www.fama.co.za

PROJECT TITLE  
**16 Solent Rd**

**16 Solent Rd, London, NW6 1TU**

DRAWING TITLE  
**Proposed Section AA & BB**

DRAWING SCALE <b>As indicated</b>	A1	DRAWN FJ	DATE 14/04/2026
DRAWING NUMBER <b>1807 AD-2001</b>		REV # <b>B</b>	