

ANNOTATION KEY :

1	EXISTING OPENING AMENDED. NEW MULTI PANEL VACUUM GLAZED VICTORIAN STYLE WINDOW PROPOSED.	6	ROOF COVERINGS (SLATE) AND LEAD TO BE REPLACED WHERE NECESSARY TO MATCH EXISTING.
2	NEW MULTI PANEL VICTORIAN STYLE SASH WINDOWS WITH SLIMLINE GLAZING IN EXISTING OPENING.	7	ALL RAINWATER GOODS TO BE REMOVED & REPLACED WITH CAST IRON TO MATCH EXISTING STYLE & COLOUR.
3	EXISTING OPENING CLOSED UP & MADE GOOD. EXISTING FENESTRATION REMOVED.	8	RENDER FINISH TO BE REPAINTED. RAL COLOUR TBC.
4	NEW VICTORIAN STYLE DOUBLE DOOR IN EXISTING OPENING.	9	EXISTING RAILINGS TO BE RETAINED AND REPAINTED
5	ROOF COVERINGS (SLATE) AND LEAD TO BE REPLACED WHERE NECESSARY TO MATCH EXISTING.		

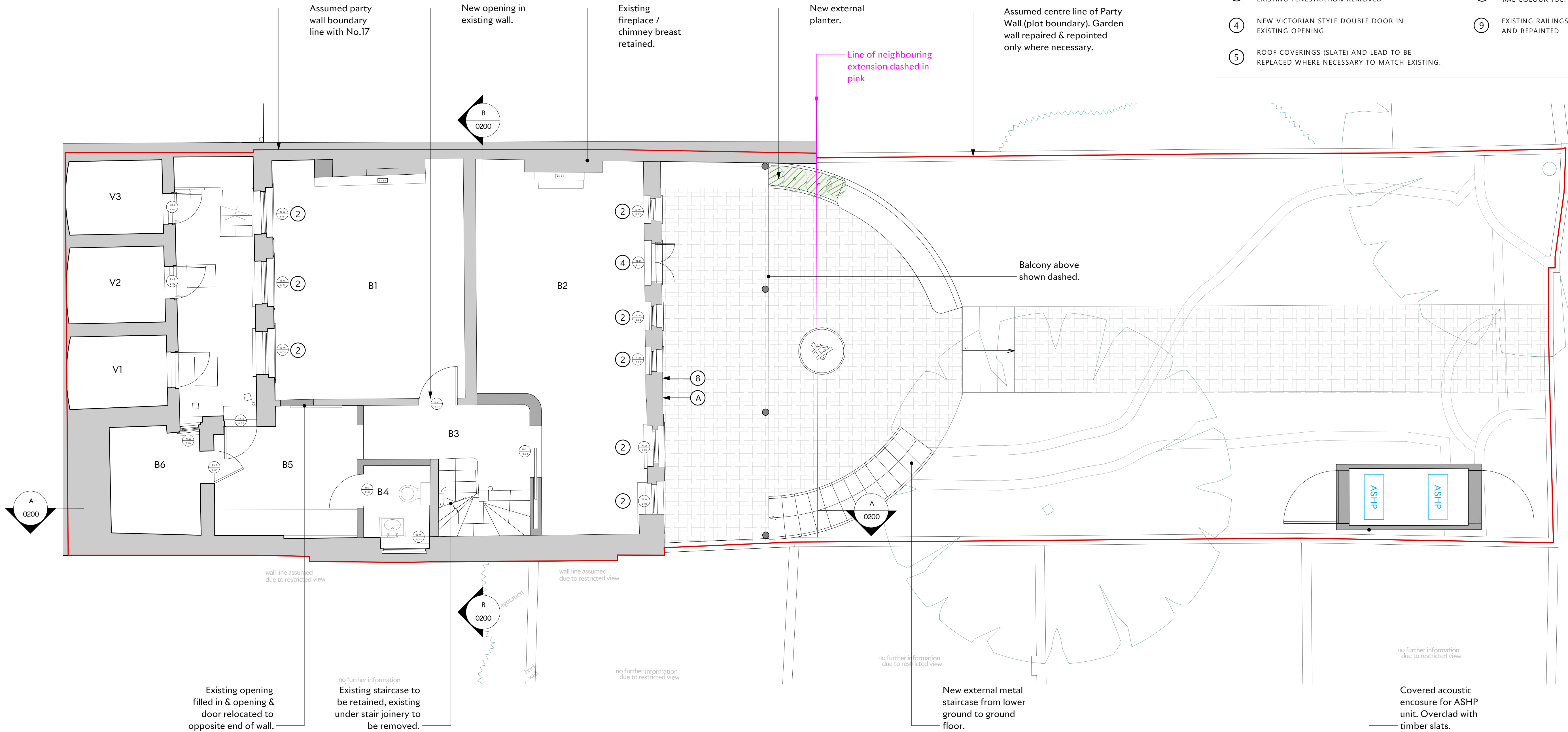

**GENERAL NOTE :**  
RESTORATION / REINSTATEMENT OF HISTORIC FEATURES SUCH AS CORNICING, SKIRTING, ARCHITRAVES WITH AGE APPROPRIATE ALTERNATIVE WHERE NECESSARY.

FINISHES KEY :

A	RENDER - COLOUR TBC
B	SLATE
C	BRICK
D	METAL

Notes

- Drawings are to be read in conjunction with all relevant Architects, Structural Engineers and other consultants information, drawings & schedules.
- All works to be carried out in accordance with current Health & Safety regulations, British Standards, Building Regulations and industry standard where appropriate.
- All components to be based on the design intent drawings and to the dimensions shown. Any further design development to be issued by manufacturer as detailed drawings and finish samples for approval by Designer prior to manufacture and must not infringe any design copyright.
- Do not scale from drawings. All dimensions to be confirmed on site & coordinated with Design Team.
- Contractor to refer all discrepancies and/or errors to Architect.
- All fire rating, acoustic rating and any other specialist requirements to be confirmed by appropriate specialist engineer.
- Tender documentation for costing purposes only. Unless marked as "For Construction" drawings are not to be used for construction.

ANNOTATION KEY :

EXISTING - ORIGINAL WALLS
EXISTING - NON ORIGINAL WALLS
PROPOSED
ASSUMED SITE BOUNDARY

**GENERAL NOTE:**  
ALL FLOOR LEVELS SHOWN ARE AOD.

P 1 14/05/2025 ISSUED FOR PLANNING

PLANNING

Project  
**15 Chalcot Square, NW1 8YA**  
Client  
**Bridget Smith**  
Drawing Title  
**Proposed Lower Ground Floor Plan**

Scale  
**1:50**  
Date Created  
**A1 09/10/2024**

Drawing Number  
**24031-700**  
Revision  
**P1**  
Date Revised  
**14/05/2025**  
Drawn By  
**OM**  
Checked By  
**MD**

Do not scale from drawing, all dimensions to be checked on site. Report omissions and discrepancies to the architect immediately.

**MICHAELIS BOYD .**  
**Michaelis Boyd Associates**  
108 Palace Gardens Terrace  
London W8 4RT  
**+44 (0)20 7221 1237**  
**hello@michaelisboyd.com**  
**michaelisboyd.com**